



PERSONAL MICRO COMPONENT SYSTEM MM-DX7

THIS APPLIANCE IS MANUFACTURED BY:



ELECTRONICS

Instruction Manual

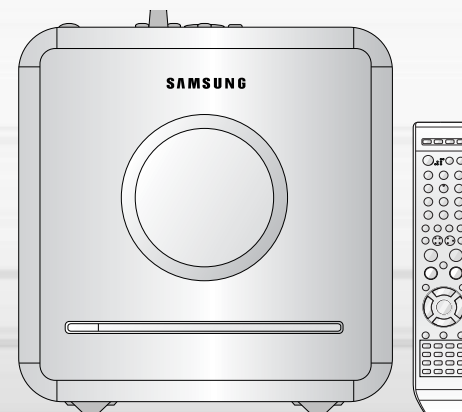

Safety Warnings

CLASS 1 LASER PRODUCT
KLASSE 1 LASER PRODUKT
LUOKAN 1 LASER LAITE
KLASS 1 LASER APPARAT
PRODUCTO LASER CLASE 1



CAUTION:
 TO REDUCE THE RISK OF ELECTRIC SHOCK, DO NOT REMOVE REAR COVER. NO USER SERVICEABLE PARTS INSIDE. REFER SERVICING TO QUALIFIED SERVICE PERSONNEL.

CLASS 1 LASER PRODUCT

This Compact Disc player is classified as a CLASS 1 LASER product.

(Saudi Arabian Standards Organization)

THIS APPLIANCE IS FITTED WITH 220V SASO APPROVED PLUG.THE CUSTOMER IS ENTITLED TO A FREE SASO APPROVED 127V PLUG FROM THE LOCAL DEALER.

Use of controls, adjustments or performance of procedures other than those specified herein may result in hazardous radiation exposure.

CAUTION-INVISIBLE LASER RADIATION WHEN OPEN AND INTERLOCKS DEFEATED, AVOID EXPOSURE TO BEAM.

- This symbol indicates that dangerous voltage which can cause electric shock is present inside this unit.
- This symbol alerts you to important operating and maintenance instructions accompanying the unit.

WARNING: To reduce the risk of fire or electric shock, do not expose this appliance to rain or moisture.

CAUTION: TO PREVENT ELECTRIC SHOCK, MATCH WIDE BLADE OF PLUG TO WIDE SLOT, FULLY INSERT.

Precautions

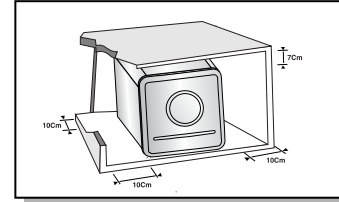

Ensure that the AC power supply in your house complies with the identification sticker located on the back of your player. Install your player horizontally, on a suitable base (furniture), with enough space around it for ventilation (3-4inches). Make sure the ventilation slots are not covered. Do not stack anything on top of the player. Do not place the player on amplifiers or other equipment which may become hot. Before moving the player, ensure the disc tray is empty. This player is designed for continuous use. Switching off the DVD player to the stand-by mode does not disconnect the electrical supply. In order to disconnect the player completely from the power supply, remove the main plug from the wall outlet, especially when left unused for a long period of time.

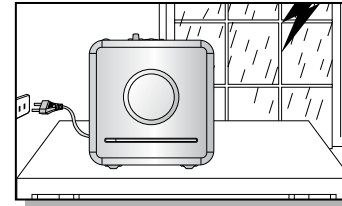

During thunderstorms, disconnect AC main plug from the wall outlet. Voltage peaks due to lightning could damage the unit.

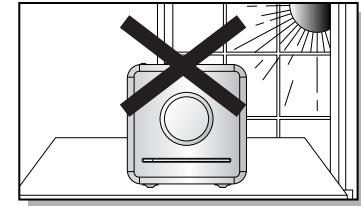

Do not expose the unit to direct sunlight or other heat sources. This could lead to overheating and malfunction of the unit.

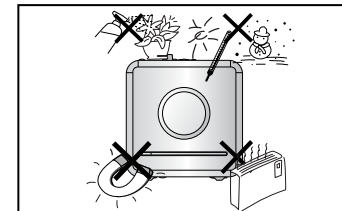

Protect the player from moisture(i.e. vases) , and excess heat(e.g.fireplace) or equipment creating strong magnetic or electric fields (i.e.speakers...). Disconnect the power cable from the AC supply if the player malfunctions. Your player is not intended for industrial use. Use of this product is for personal use only. Condensation may occur if your player or disc have been stored in cold temperatures. If transporting the player during the winter, wait approximately 2 hours until the unit has reached room temperature before using.

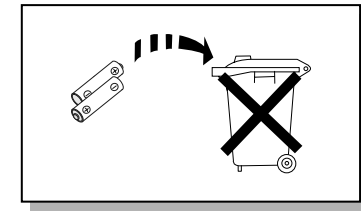

The battery used with this product contain chemicals that are harmful to the environment. Do not dispose of batteries in the general household trash.



Features

● Multi-Disc Playback & AM/FM Tuner, TAPE

The MM-DX7 combines the convenience of multi-disc playback capability, including DVD, VCD, CD, DivX, WMA, MP3-CD, CD-R, CD-RW, and DVD-RW, with a sophisticated AM/FM tuner, TAPE, all in a single player.

● TV Screen Saver Function

The MM-DX7 automatically brightens and darkens the brightness of the TV screen after 3 minutes in the stop .

● Power Saving Function

The MM-DX7 automatically shuts itself off after 20 minutes in the stop .

● Customized TV Screen Display

The MM-DX7 allows you to select your favourite image during JPEG, DVD playback and set it as your background wallpaper.



DVD (Digital Versatile Disc) offers fantastic audio and video, thanks to Dolby Digital surround sound and MPEG-2 video compression technology. Now you can enjoy these realistic effects in the home, as if you were in a movie theater or concert hall.



DVD players and the discs are coded by region. These regional codes must match in order for the disc to play. If the codes do not match, the disc will not play.

The Region Number for this player is given on the rear panel of the player.
(Your DVD player will only play DVDs that are labeled with identical region codes.)

Copy Protection

- Many DVD discs are encoded with copy protection. Because of this, you should only connect your DVD player directly to your TV, not to a VCR. Connecting to a VCR results in a distorted picture from copy-protected DVD discs.
- This product incorporates copyright protection technology that is protected by methods claims of certain U.S. patents and other intellectual property rights owned by Macrovision Corporation and other rights owners. Use of this copyright protection technology must be authorised by Macrovision Corporation, and is intended for home and other limited viewing uses only unless otherwise authorised by Macrovision Corporation. Reverse engineering or disassembly is prohibited.



Contents

● PREPARATION	
Safety Warnings.....	1
Precautions	2
Features	3
Description	5
● CONNECTIONS	
Connecting the Speakers.....	9
Connecting to a TV.....	10
Connecting to External Components.....	11
Connecting the FM and AM(MW) Antennas	12
P.SCAN (Progressive Scan) Function.....	13
Setting the Clock.....	14
● OPERATION	
Disc Playback	15
Mp3/WMA-CD Playback	16
DivX Playback	17
Displaying Disc Information	19
Fast/Slow Playback	20
Skipping Scenes/Songs	21
Angle Function.....	22
Repeat Playback.....	23
Selecting Audio/Subtitle Language	25
Moving Directly to a Scene/Song.....	26
JPEG File Playback	27
Zoom Function.....	28
Using Disc Menu	29
Using the Title Menu	30
● SETUP	
Setting the Language.....	31
Language Code List.....	32
Setting TV Screen type.....	33
Setting Parental Controls (Rating Level).....	35
Setting the Password.....	36
Setting the Wallpaper.....	37
Setting the DRC (Dynamic Range Compression).....	39
AV SYNC Setup.....	40
● USB Playing USB.....	41
Selecting a Track from USB Device.....	42
To use high speed search.....	43
● RADIO OPERATION	
Listening to Radio	44
Presetting Stations.....	45
● TAPE DECK	
Listening to a Cassette.....	46
Selecting the cassette Playback Mode/Repeat A+B Function.....	47
Tape Counter Function.....	47
● MISCELLANEOUS	
Timer Function	48
Cancelling the Timer.....	49
Recording a Compact Disc.....	50
Recording a Radio Program	52
EQ/Sound Mode/Treble/Bass Function	53
Sleep Timer Function / Mute Function.....	54
DEMO / COLOR Function.....	55
Connecting Headphones/Microphone(option).....	56
Key Control Function.....	56
Cautions on Handling and Storing Discs	57
Before Calling for Service	58
Notes on Discs.....	60
Notes on Terminology.....	61
Specifications.....	62
USB Feature Supported Player.....	63

Description

—Top Panel—

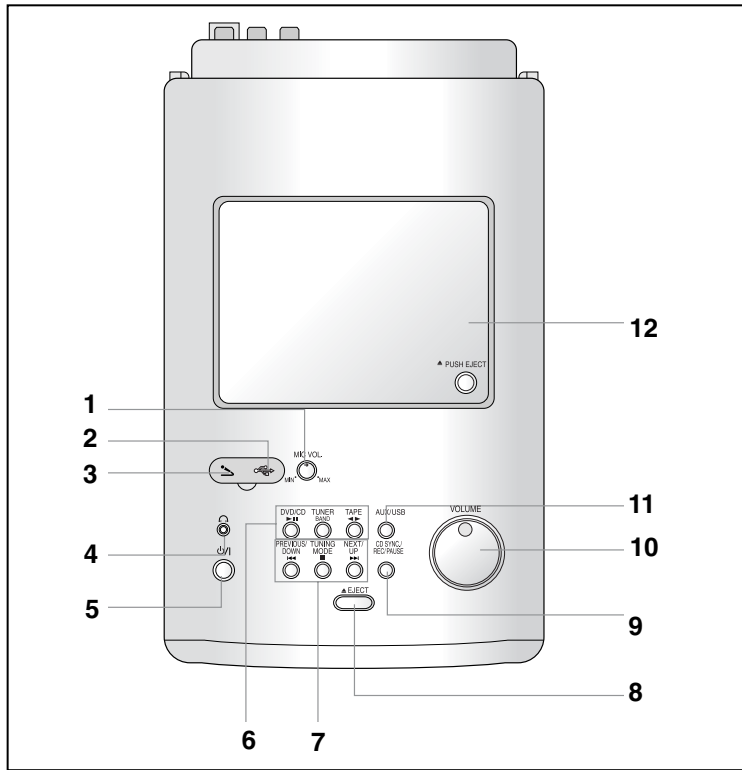

- | | |
|--|---------------------------|
| 1. MIC VOL | 8. EJECT |
| 2. USB JACK | 9. CD SYNCHRO / REC/PAUSE |
| 3. MIC JACK | 10. VOLUME CONTROL |
| 4. HEADPHONE JACK CONNECTOR | 11. AUX/USB |
| 5. STANDBY/ON | 12. CASSETTE DECK |
| 6. FUNCTIONS (DVD/CD/TUNER/TAPE) | |
| 7. SEARCH FUNCTION BUTTONS
TUNING MODE OR STOP BUTTON | |

—Rear Panel—

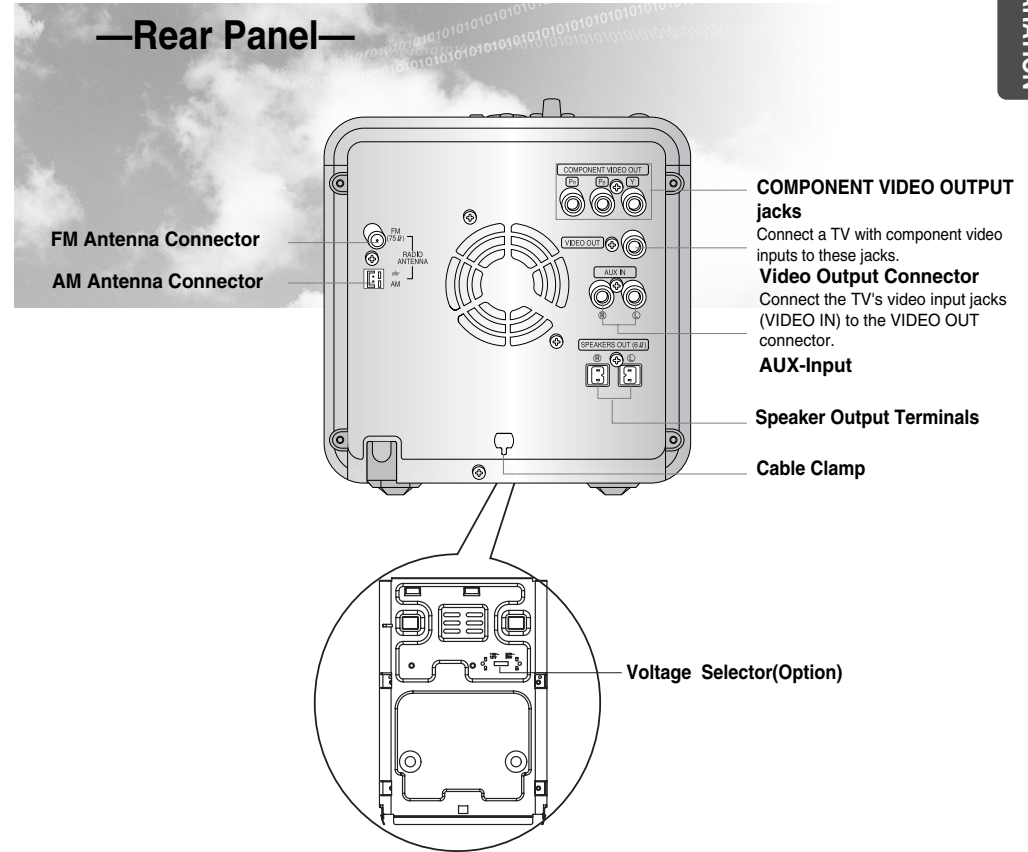

FM Antenna Connector
AM Antenna Connector

COMPONENT VIDEO OUTPUT jacks

Connect a TV with component video inputs to these jacks.

Video Output Connector
Connect the TV's video input jacks (VIDEO IN) to the VIDEO OUT connector.

AUX-Input

Speaker Output Terminals

Cable Clamp

Voltage Selector(Optional)

Accessories

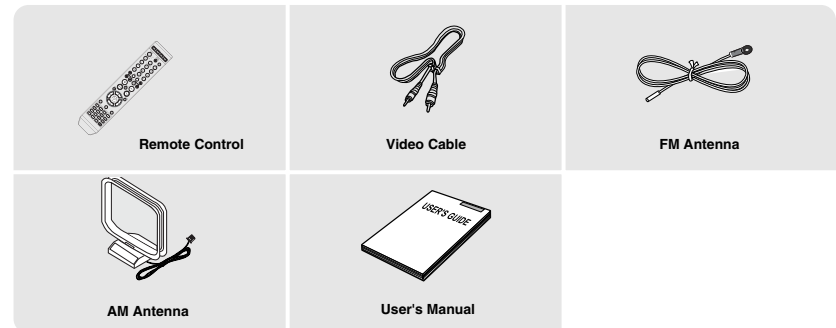

Remote Control

Video Cable

FM Antenna

AM Antenna

User's Manual

Description

—Remote Control—

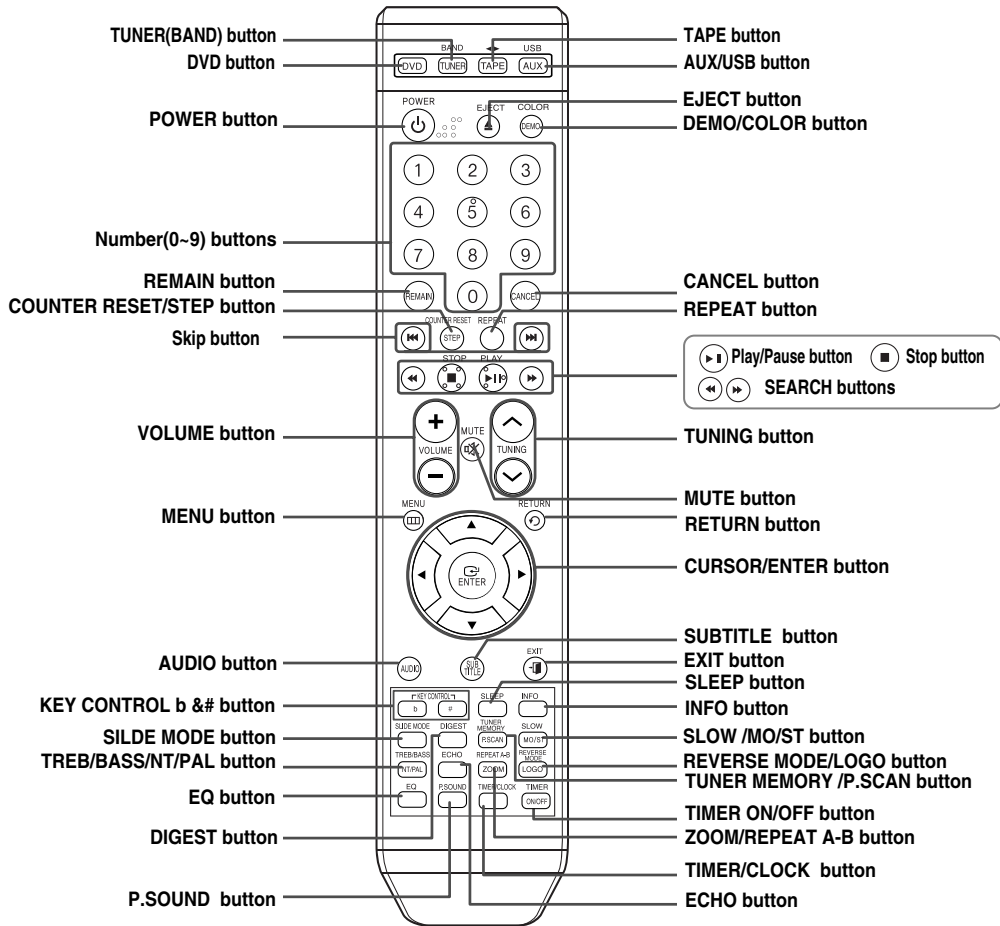

Insert Remote Batteries

- 1 Remove the battery cover on the back of the remote by pressing down and sliding the cover in the direction of the arrow.
- 2 Insert two 1.5V AAA batteries, paying attention to the correct polarities (+ and -).
- 3 Replace the battery cover.

- Caution** Follow these precautions to avoid leaking or cracking cells:
- Place batteries in the remote control so they match the polarity:(+) to (+)and (-)to (-).
 - Use the correct type of batteries.Batteries that look similar may differ in voltage.
 - Always replace both batteries at the same time.
 - Do not expose batteries to heat or flame.

Range of Operation of the Remote Control

The remote control can be used up to approximately 23 feet/7 meters in a straight line. It can also be operated at a horizontal angle of up to 30° from the remote control sensor.

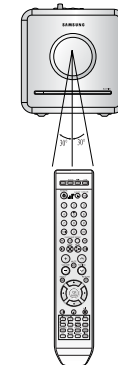



Connecting the Speakers

Before moving or installing the product, be sure to turn off the power and disconnect the power cord.

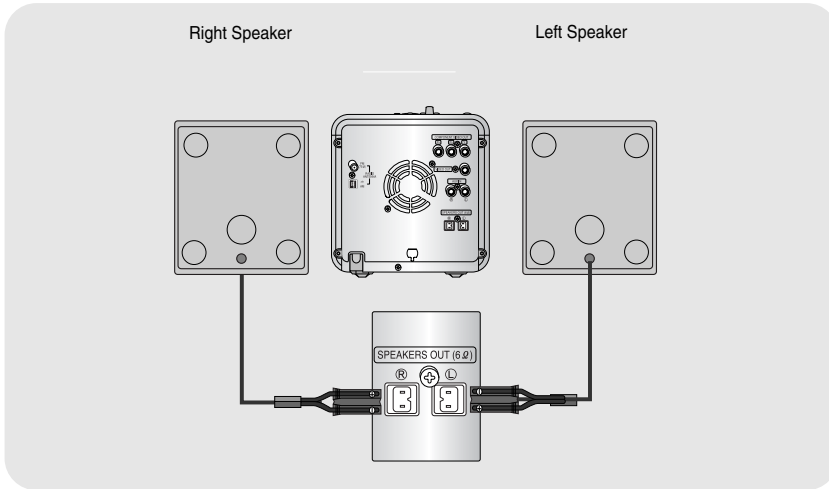

Position of the DVD Player

- Place it on a stand or cabinet shelf, or under the TV stand.

Loudspeakers **L R**

- Place these speakers in front of your listening position, facing inwards (about 45°) toward you.
- Place the speakers so that their tweeters will be at the same height as your ear.

Directions in Installing Speaker

- Installation in a place near heating apparatus, under direct lay of light or with high humidity may cause performance degradation of the speaker.
- Do not install on the wall or on a high place of pole or other unstable place to prevent any safety accident caused by falling of the speaker.
- Do not take the speaker apart from TV or computer monitor.
The speaker near the TV or computer monitor may influence the quality of the screen display.



Connecting to a TV

Please be sure to turn off the power and unplug the power cord before moving or installing this unit. Please choose one of two video connection methods.

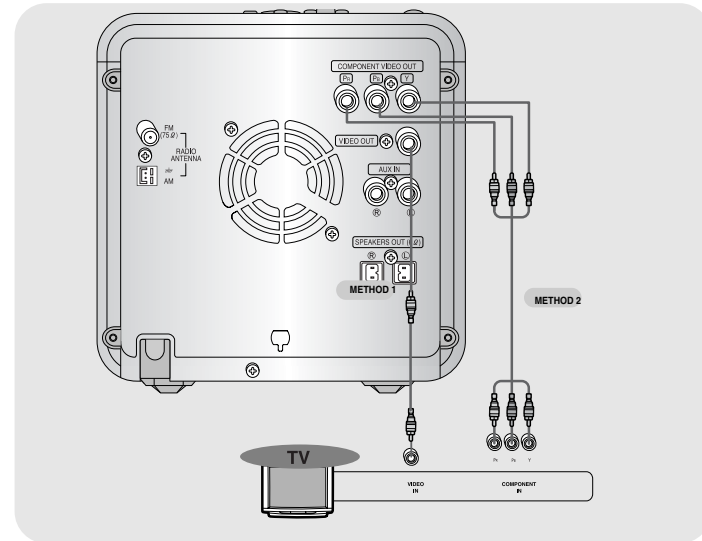

CONNECTIONS

METHOD 1 Composite Video Good Quality

Connect the supplied video cable from the VIDEO OUT jack on the back panel of the system to the VIDEO IN jack on your television.

METHOD 2 Component (Progressive Scan) Video Best Quality

If your television is equipped with Component Video inputs, connect a component video cable (not supplied) from the Pr, Pb and Y jacks on the back panel of the system to the corresponding jacks on your television.



Connecting to External Components

Connecting to an External Analog Component

Example: Analog signal components such as a VCR, Camcorder, and TV.

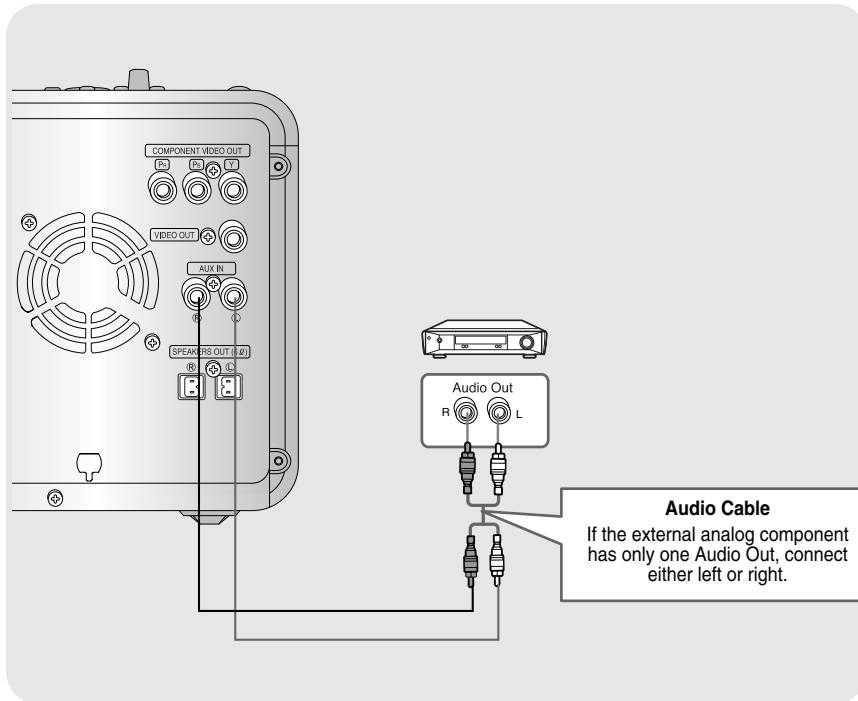

- 1 Connect Audio In on the DVD player to Audio Out on the external analog component.
 - Be sure to match connector colors.
- 2 Press **AUX** to select AUX.
 - 'AUX' appears in the display.



Connecting the FM and AM(MW) Antennas

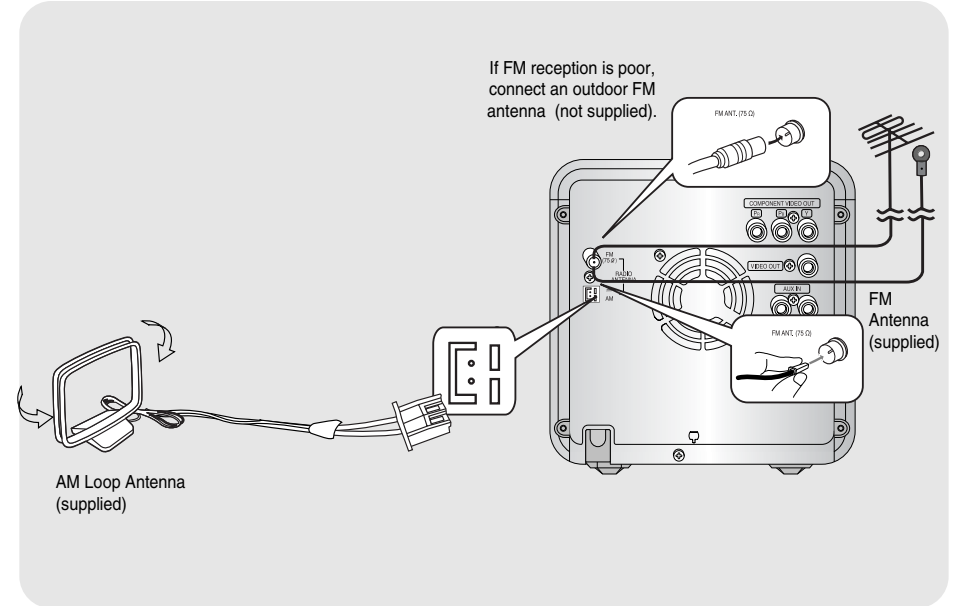

FM antenna connection

1. Connect the FM antenna supplied to the FM 75Ω COAXIAL terminal as a temporary measure.
2. Slowly move the antenna wire around until you find a location where reception is good, then fasten it to a wall or other rigid surface.

- If reception is poor, connect an outdoor antenna. Before attaching a 75Ω coaxial cable (with a standard type connector), disconnect the supplied FM antenna.

AM(MW) antenna connection

1. Connect the AM loop antenna supplied to the AM and π terminals.
2. If reception is poor, connect an outdoor single vinyl-covered wire to the AM terminal. (Keep the AM loop antenna connected).

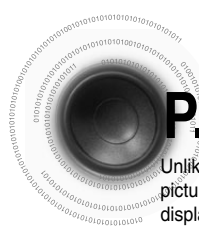

P.SCAN(Progressive Scan) Function

Unlike regular Interlace Scan, in which two fields of picture information alternate to create the entire picture (odd scan lines, then even scan lines), Progressive Scan uses one field of information (all lines displayed in one pass) to create a clear and detailed picture without visible scan lines.

1 Press STOP button.

- If playing a disc, press the **STOP** button twice so that "STOP", appears on the display.

2 Press and hold P.SCAN button on the remote control for over 5 seconds.

- Pressing and holding the button for over 5 seconds will select "Progressive Scan" and "Interlace Scan" alternately.
- When you select P.SCAN, "P.SCAN" will appear on the display.
- To set P.Scan mode for DivX and MP3 discs, press the **P.SCAN** button on the remote control for more than 5 seconds with no disc in the unit ("NO DISC" on the display), then load the DivX disc and play.

What is Progressive (or Non-Interlaced) Scanning?

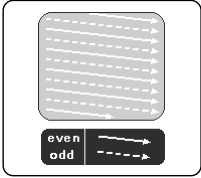
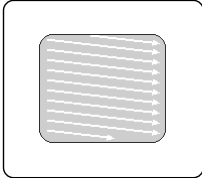
Interlaced Scan (1 FRAME = 2 FIELDS)	Progressive Scan (FULL FRAME)
 <p>In interlaced-scan video, a frame consists of two interlaced fields (odd and even), where each field contains every other horizontal line in the frame. The odd field of alternating lines is displayed first, and then the even field is displayed to fill in the alternating gaps left by the odd field to form a single frame. One frame, displayed every 1/25th of a second, contains two interlaced fields, thus a total of 50 fields are displayed every 1/50th of a second. The interlaced scanning method is intended for capturing a still object.</p>	 <p>The progressive scanning method scans one full frame of video consecutively down the screen, line by line. An entire image is drawn at one time, as opposed to the interlaced scanning process by which a video image is drawn in a series of passes. The progressive scanning method is desirable for dealing with moving objects.</p>

Note

- This function works only on TVs equipped with component video inputs (Y, Pr, Pb) that support Progressive Video. (It does not work on TVs with conventional component inputs, i.e., non-progressive scan TVs.)
- Depending on the capabilities of your TV, this function may not work.



Setting the Clock



For each step, you have a few seconds to set the required options. If you exceed this time, you must start again.

1 Switch the system on by pressing POWER button.

2 Press TIMER/CLOCK twice.

- CLOCK is displayed.

3 Press ENTER. The hour flashes.

- Increase the hours : 
- Decrease the hours : 

4 When the correct hour is displayed, press ENTER. The minutes flash.

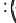
- Increase the minutes : 
- Decrease the minutes : 

5 When the correct time is displayed, press ENTER.

- "TIMER" appears in the display.
- The current time is now set.

Note

- You can display the time, even when you are using another function, by pressing **TIMER/CLOCK** once.

Selecting the Video Format

Turn off the main unit and then press and hold **NT/PAL** button on the remote controller for over 5 seconds .

- By default, the video format is set to "PAL".
- "NTSC" and "PAL" will appear in the display. At this time, press the NT/PAL button shortly to select between "NTSC" and "PAL".
- Each country has a different video format standard.
- For normal playback, the video format of the disc must be the same as the video format of your TV.

Checking the Remaining Time

Press the REMAIN button.

- For checking the total and remaining time of a title or chapter being played.

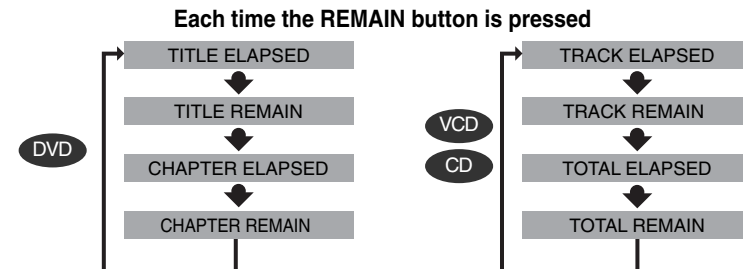

Disc Playback

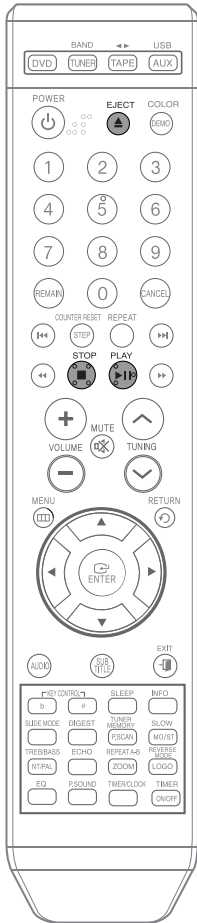

1 Load a disc.
• Insert a disc that the disc's label facing up.

2 To eject the disc, press **EJECT** button

DVD VCD CD

• Playback starts automatically.

MP3 DivX JPEG

• Playback starts automatically.
• If the TV is on, a list of MP3s on the CD will appear on the TV screen.



Note

- Depending on the content of the disc, the initial screen may appear different.
- Depending on the recording mode, some MP3-CDs cannot be played.
- Table of contents of a MP3-CD varies depending on the MP3 track format recorded on the disc.

To stop playback, press **STOP** during playback.

- If pressed once, "PRESS PLAY" is displayed and the stop position will be stored in memory. If **PLAY/PAUSE** (▶||) button or **ENTER** button is pressed, playback resumes from the stop position. (This function works only with DVDs.)
- If pressed twice, "STOP" is displayed, and if **PLAY/PAUSE** (▶||) button is pressed, playback starts from the beginning.

To temporarily pause playback, press **PLAY/PAUSE** during playback.

- To resume playback, press **PLAY/PAUSE** button again.

MP3/WMA-CD Playback

Data CDs (CD-ROM, CD-R, CD-RW) encoded in MP3/WMA format can be played.



1 Load the MP3/WMA disc.

- The MP3/WMA menu screen will appear and playback will start.
- The appearance of the menu depends on the MP3/WMA disc.
- WMA-DRM files cannot be played.



3 To change the album, use ◀ ▶ ▲ ▼ to select another album in Stop mode, and then press the **ENTER** button.

- To select another album and track, repeat Steps 2 and 3 above.

Note

- Depending on the recording mode, some MP3/WMA-CDs may not play.
- Table of contents of a MP3-CD varies depending on the MP3/WMA track format recorded on the disc.

2 In Stop mode, use ◀ ▶ ▲ ▼ to select the album, and then press the **ENTER** button.

- Use ▲ ▼ to select the track.

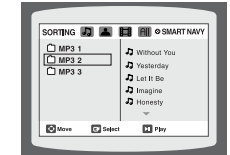

4 Press the **STOP** button to stop playback.

To play a file icon in the screen,

Press the ◀ ▶ ▲ ▼ button when it is in stop status and select a desired icon from the top part of the menu.

- To play music files only, select the 🎵 icon.
- To view image files only, select the 🖼️ icon.
- To view movie files only, select the 🎬 icon.
- To select all files select the 📁 icon.

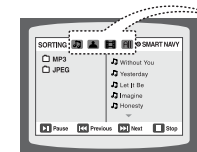

- Music File Icon
- Image File Icon
- Movie File Icon
- All File Icon

Displaying Disc Information

You can view playback information on the disc on the TV screen.

Press **INFO** button.

- Each time the button is pressed, the display changes as follows:

DVD



↓



↓

Display disappears

VCD CD



↓

Display disappears

MP3 DivX JPEG



↓

Display disappears

Note

- Depending on the disc, the disc information display may appear different.

- What is a Title?**
A movie contained in a DVD disc.
- What is a Chapter?**
Each title on a DVD disc is divided into several smaller sections called "chapters".
 -  **appears on the TV screen!**
If this symbol appears on the TV screen while buttons are being operated, that operation is not possible with the disc currently being played.
- What is a Track (File)?**
A section of video or a music file recorded on a VCD, CD, or MP3-CD.

Screen Display

 DVD display	 TRACK (FILE) display	 AUDIO LANGUAGE display	 DOLBY DIGITAL display
 VCD display	 TITLE display	 ELAPSED TIME display	 SUBTITLE display
 CD display	 REPEAT PLAYBACK display	 LR STEREO (L/R) display	 ANGLE display
		 CHAPTER display	

Fast/Slow Playback

Fast Playback DVD VCD CD MP3

Press **◀◀▶▶** button.

- Each time the button is pressed during playback, the playback speed changes as follows:

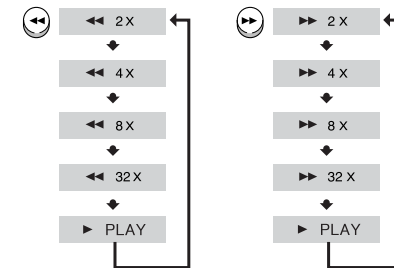

Slow Playback

Press **SLOW** button.

- Each time the button is pressed during playback, the playback speed changes as follows:

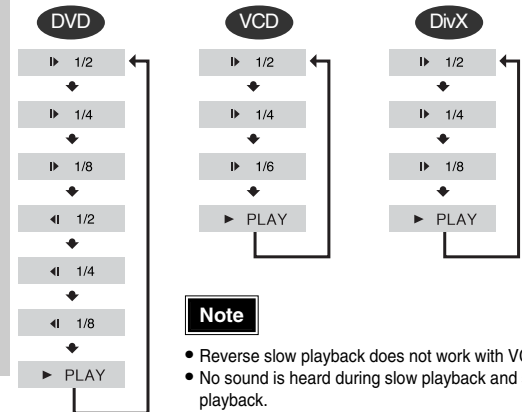

Note

- Reverse slow playback does not work with VCDs and DivX.
- No sound is heard during slow playback and step motion playback.

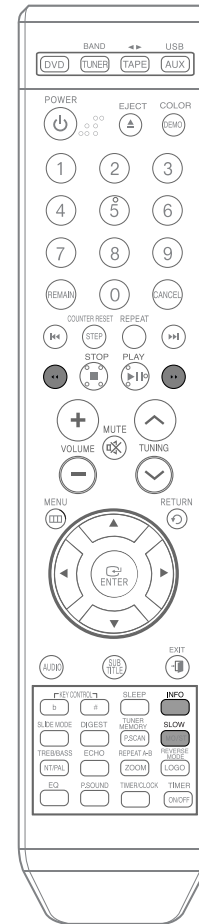

Selecting Audio/Subtitle Language

Audio Language Selection Function DVD

1 Press **INFO** button twice.

DVD EN 1/3 OFF/ 02 OFF

2 Press Cursor **▲**, **▼** buttons or numeric buttons to select the desired audio language.

- Depending on the number of languages on a DVD disc, a different audio language (KOREAN, ENGLISH, JAPANESE, etc.) is selected each time the button is pressed.

DVD EN 1/3
 SP 2/3
 FR 3/3

Note • You can use the Audio button on the remote control to select a Audio language.

Subtitle Language Selection Function DVD

1 Press **INFO** button twice.

DVD EN 1/3 OFF/ 02 OFF

2 Press Cursor **▶** button to move to **SUBTITLE** display.

DVD EN 1/3 OFF/ 02 OFF

3 Press Cursor **▼** button or numeric buttons to select the desired subtitle.

DVD EN 1/3 EN 01/ 03 OFF
 SP 02/ 03
 FR 03/ 03
 OFF / 03

Note

- You can use the **SUBTITLE** button on the remote control to select a subtitle language.
- Depending on the disc, the Subtitle and Audio Language functions may not work.

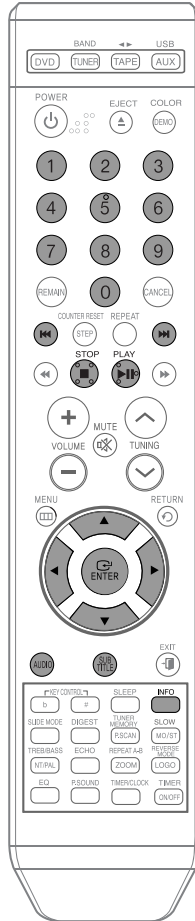

Moving Directly to a Scene/Song

DVD VCD CD

1 Press **INFO** button.

DVD 01:05 001/040 0:00:37 1/1

Moving to a Chapter

4 Press Cursor **▲**, **▼** buttons or numeric buttons to select the desired chapter and then press **ENTER** button.

DVD 01:05 025/040 0:00:01 1/1

Moving to a Title/Track

2 Press Cursor **▲**, **▼** buttons or numeric buttons to select the desired title/track and then press **ENTER** button.

DVD 03:05 001/002 0:00:01 1/1

Moving to a Specific Time

5 Press Cursor **◀**, **▶** buttons to move to time display.

DVD 01:05 025/040 1:17:30 1/1

Moving to a Chapter

3 Press Cursor **◀**, **▶** buttons to move to Chapter display.

DVD 01:05 001/040 0:00:01 1/1

Moving to a Specific Time

6 Press the numeric buttons to select the desired time and then press **ENTER** button.

DVD 01:05 025/040 1:30:00 1/1

MP3 JPEG

Press the **numeric** buttons.

- The selected file will be played.
- An MP3 or JPEG disc cannot be moved from the disc information screen.
- When playing an MP3 or JPEG disc, you cannot use **▲**, **▼** to move a folder. To move a folder, press **■** (Stop) and then press **▲**, **▼**.



Note

- You can press **◀◀▶▶** on the remote control to move directly to the desired title, chapter, or track.
- Depending on the disc, you may not be able to move to the selected title or time.

OPERATION

Using Disc Menu

You can use the menus for the audio language, subtitle language, profile, etc. DVD menu contents differ from disc to disc.

Using the Title Menu

For DVDs containing multiple titles, you can view the title of each movie. Depending on the disc, this function may either not work at all or may work differently.

VCD

1 Press **MENU** button in the stop mode.

- When playing a VCD (version 2.0), this toggles between PBC ON and OFF.



2 Press Cursor **▲, ▼** buttons to move to 'DISC MENU' and then press **ENTER** button.

- When you select the disc menu that is not supported by the disc, the "This menu is not supported" message appears on the screen.



3 Press Cursor **▲, ▼, ◀, ▶** buttons to select the desired item.



4 Press **ENTER** button.



Note

PBC (Playback Control) Function

When playing a VCD (version 2.0), you can select and view various scenes according to the menu screen.

PBC ON (MENU ON): This VCD disc is version 2.0. The disc is played back according to the menu screen. Some functions may be disabled. When some functions are disabled, select "MENU OFF" to enable them.

PBC OFF (MENU OFF): This VCD disc is version 1.1. The disc is played back in the same way as with a music CD.



DVD

1 Press **MENU** button in the stop mode.



2 Press Cursor **▲, ▼** button to move to 'Title Menu'.



3 Press **ENTER** button.

- The title menu appears.



Press **MENU** or **EXIT** button to exit the setup screen.

OPERATION

Setting the Language

OSD language is set to English by default.

1 Press **MENU** button in the stop mode.



2 Press Cursor **▼** button to move to 'Setup' and then press **ENTER** button.



3 Press **ENTER** button.



4 Press Cursor **▲, ▼** button to select the desired item and then press **ENTER** button.



Selecting the OSD Language

5 Press Cursor **▲, ▼** button to select the desired language and then press **ENTER** button.



Selecting the Audio Language (recorded on the disc)

Note

- To select other language, select OTHER and enter the language code of your country. (See 32 page for language code of countries)
AUDIO, SUB TITLE and DISC MENU language can be selected.



Selecting the Subtitle Language (recorded on the disc)

Selecting the Disc Menu Language (recorded on the disc)

* If the language you selected is not recorded on the disc, menu language will not change even if you set it to your desired language.

Press **RETURN** button to return to the previous level.

Press **MENU** or **EXIT** button to exit the setup screen.

Language Code List

Enter the appropriate code number for the initial settings "Disc Audio", "Disc Subtitle" and/or "Disc Menu" (See page 31).

Code	Language	Code	Language	Code	Language	Code	Language
1027	Afar	1181	Frisian	1334	Latvian, Lettish	1506	Slovenian
1028	Abkhazian	1183	Irish	1345	Malagasy	1507	Samoan
1032	Afrikaans	1186	Scots Gaelic	1347	Maori	1508	Shona
1039	Amharic	1194	Galician	1349	Macedonian	1509	Somali
1044	Arabic	1196	Guarani	1350	Malayalam	1511	Albanian
1045	Assamese	1203	Gujarati	1352	Mongolian	1512	Serbian
1051	Aymara	1209	Hausa	1353	Moldavian	1513	Siswati
1052	Azerbaijani	1217	Hindi	1356	Marathi	1514	Sesotho
1053	Bashkir	1226	Croatian	1357	Malay	1515	Sundanese
1057	Byelorussian	1229	Hungarian	1358	Maltese	1516	Swedish
1059	Bulgarian	1233	Armenian	1363	Burmese	1517	Swahili
1060	Bihari	1235	Interlingua	1365	Nauru	1521	Tamil
1069	Bislama	1239	Interlingue	1369	Nepali	1525	Tegulu
1066	Bengali; Bangla	1245	Inupiak	1376	Dutch	1527	Tajik
1067	Tibetan	1248	Indonesian	1379	Norwegian	1528	Thai
1070	Breton	1253	Icelandic	1393	Occitan	1529	Tigrinya
1079	Catalan	1254	Italian	1403	(Afan) Oromo	1531	Turkmen
1093	Corsican	1257	Hebrew	1408	Oriya	1532	Tagalog
1097	Czech	1261	Japanese	1417	Punjabi	1534	Setswana
1103	Welsh	1269	Yiddish	1428	Polish	1535	Tonga
1105	Danish	1283	Javanese	1435	Pashto, Pushto	1538	Turkish
1109	German	1287	Georgian	1436	Portuguese	1539	Tsonga
1130	Bhutani	1297	Kazakh	1463	Quechua	1540	Tatar
1142	Greek	1298	Greenlandic	1481	Rhaeto-Romance	1543	Twi
1144	English	1299	Cambodian	1482	Kirundi	1557	Ukrainian
1145	Esperanto	1300	Kannada	1483	Romanian	1564	Urdu
1149	Spanish	1301	Korean	1489	Russian	1572	Uzbek
1150	Estonian	1305	Kashmiri	1491	Kinyarwanda	1581	Vietnamese
1151	Basque	1307	Kurdish	1495	Sanskrit	1587	Volapuk
1157	Persian	1311	Kirghiz	1498	Sindhi	1613	Wolof
1165	Finnish	1313	Latin	1501	Sangro	1632	Xhosa
1166	Fiji	1326	Lingala	1502	Serbo-Croatian	1665	Yoruba
1171	Faeroese	1327	Laothian	1503	Singhalese	1684	Chinese
1174	French	1332	Lithuanian	1505	Slovak	1697	Zulu



Setting TV Screen type



1 Press **MENU** button in the stop mode.



2 Press Cursor \blacktriangledown button to move to 'Setup' and then press **ENTER** button.



3 Press Cursor \blacktriangledown button to move to 'TV DISPLAY' and then press **ENTER** button.



4 Press Cursor $\blacktriangle, \blacktriangledown$ button to select the desired item and then press **ENTER** button.

• Once the setup is complete, you will be taken to the previous screen.



Adjusting the TV Aspect Ratio (Screen Size)

The horizontal to vertical screen size ratio of conventional TVs is 4:3, while that of wide screen and high definition TVs is 16:9. This ratio is called the aspect ratio. When playing DVDs recorded in different screen size, you should adjust the aspect ratio to fit your TV or monitor.

* For a standard TV, select either "4:3LB" or "4:3PS" option according to personal preference. Select "16:9" if you have a wide screen TV.

WIDE

: Select this to view a 16:9 picture in the full-screen mode on your wide screen TV.
• You can enjoy the wide screen aspect.



4:3LB (4:3 Letter box)

: Select this to play a 16:9 picture in the letter box mode on a conventional TV.
• Black bars will appear at the top and bottom of the screen.



4:3PS (4:3 Pan&Scan)

: Select this to play a 16:9 picture in the pan & scan mode on a conventional TV.
• You can see the central portion of the screen only (with the sides of the 16:9 picture cut off).



Note

- If a DVD is in the 4:3 ratio, you cannot view it in wide screen.
- Since DVD discs are recorded in various image formats, they will look different depending on the software, the type of TV, and the TV aspect ratio setting.

Press **RETURN** button to return to the previous level.

Press **MENU** or **EXIT** button to exit the setup screen.

Setting Parental Controls (Rating Level)

Use this to restrict playback of adult or violent DVDs you do not want children to view.

1 Press **MENU** button in the stop mode.



2 Press Cursor ▼ button to move to 'Setup' and then press **ENTER** button.



3 Press Cursor ▼ button to move to 'PARENTAL' and then press **ENTER** button.



4 Press Cursor ▲, ▼ button to select the desired rating level and then press **ENTER** button.



5 Enter the password and then press **ENTER** button.



Note

• This function works only if a DVD disc contains the rating level information.

Setting the Password

You can set the password for the Parental (rating level) setting.

1 Press **MENU** button in the stop mode.



2 Press Cursor ▼ button to move to 'Setup' and then press **ENTER** button.



3 Press Cursor ▼ button to move to 'PASSWORD' and then press **ENTER** button.



4 Press **ENTER** button.



5 Enter the password and then press **ENTER** button.



Note

• The password is set to "7890" by default.

SETUP

Press **RETURN** button to return to the previous level.

Press **CANCEL** button to cancel the error numeric when you inputting password.

Press **MENU** or **EXIT** button to exit the setup screen.

If you have forgotten the rating level password, do the following:

- While the player is in the no disc mode, hold the main unit's **TUNING MODE/** button for longer than 5 seconds. "INITIALIZE" appears on the display and all settings will return to the default values.
- Press the **POWER** button.

Using the **RESET** function will erase all stored settings. Do not use this unless necessary.



Setting the Wallpaper JPEG

While watching a DVD, VCD, or JPEG CD, you can set the image you like as a wallpaper.

Setting the Wallpaper

1 During playback, press **PLAY/PAUSE** button when the image you like comes up.

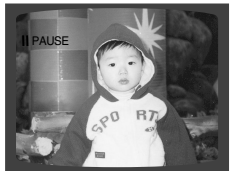

2 Press **LOGO** button.

• "LOGO COPY DATA" will be displayed on the TV screen.



3 The power will turn off and then back on and will play the disc automatically.

• The selected wallpaper will be displayed.



To Change the Wallpaper

1 Press **MENU** button in the stop mode.



2 Press Cursor **▼** button to move to 'Setup' and then press **ENTER** button.



3 Press Cursor **▼** button to move to 'LOGO' and then press **ENTER** button.



4 Press **▼** to select the desired 'USER', and then press **ENTER**.



5 Press **MENU** button to exit the setup screen.

SETUP



Select this to set the Samsung Logo image as your wallpaper.



Select this to set the desired image as your wallpaper.

Press **RETURN** button to return to the previous level.

Press **MENU** or **EXIT** button to exit the setup screen.

Setting the DRC (Dynamic Range Compression)

You can use this function to enjoy Dolby Digital sound when watching movies at low volume at night.

AV SYNC Setup

Video may look slower than the audio if it is connected with digital TV. In this case, adjust the delay time of audio to optimal status to fit the video.



1 Press **MENU** button in the stop mode.



2 Press Cursor **▼** button to move to 'Audio' and then press **ENTER** button.



3 If "DRC" is selected, press **ENTER**.



4 Press Cursor **▲, ▼** to adjust the 'DRC'.

- The Cursor **▲** button is pressed, the greater the effect, and the Cursor **▼** button is pressed, the smaller the effect.



1 Press the **MENU** button in the stop mode.

- Setup menu appears.



2 Press Cursor **▲, ▼** buttons to move to 'Audio' and then press **ENTER** button.

- 'Audio' menu appears.

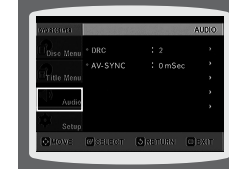

3 Press Cursor **▲, ▼** buttons to move to 'AV-SYNC' and then press **ENTER** button.

- AV-SYNC screen appears.

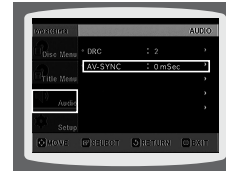

4 Press Cursor **▲, ▼** buttons to select the Delay Time of AV-SYNC and then press the **ENTER** button.

- You can set the audio delay time between 0 ms and 300 ms. Set it to the optimal status.



Press **RETURN** button to return to the previous level.

Press **MENU** or **EXIT** button to exit the setup screen.

Press **RETURN** button to return to the previous level.

Press **MENU** or **EXIT** button to exit the setup screen.

Playing USB

You can play MP3 files by connecting to various external USB storage devices such as USB flash memory or HDD.

1 Connect the external **USB** storage device to your player.

2 Select USB function by using the **USB** button.

- The first track of the first directory plays automatically.
- Do not connect USB charging device to the USB connection port of the player, because it may cause damage to the product.

To stop playing

- Press the Stop (■) button to stop.

Please be aware of the following before using USB.

- Depending on the type of external USB storage device, it may not work even if it's connected to the player.
 - With external HDD, FAT format can be played, but not NTFS format.
 - With USB 2.0 HDD, connect to a separate power source. If it's not connected to a separate power source, it may not work.
 - If memory of an external USB storage device is segmented into several parts, MP3 files of only the first hard disk drive can be played.
 - Regarding directories, up to fourth directory can be played.
 - DRM applied files are not played.
 - Digital Rights Management: Technology and service that protect the profit and rights of copyright owners by disallowing unauthorized use of digital contents.
 - Even if the file name ends with .mp3, the file does not play if actual file format is MPEG layer 1 or 2.
 - Disconnect the external USB storage device only in safe removal mode("USB REMOVE" display ON/OFF). Otherwise, internal file can be damaged.
- Press the Stop (■) button more than 2 times to get into the safe removal mode.
- If you want to play files in the safe removal mode, disconnect and reconnect the external USB storage device.
- USB hub will not be recognized.
 - Directory names are shown up to 14 letters, and MP3 file names up to 30 letters.

Delay

- When selecting USB function, depending of the speed of the external USB storage device, reading (READ-IN) internal information can take several minutes.
- When playing a USB device, recording or finding next track may introduce some delay. Especially with a mass storage device such as HDD, depending on the type and the number of files, the delay might be several minutes.
- Even with the external USB storage devices of same capacity, depending on the speed of each product, the amount of operating time can vary.
- If the external USB storage device supports only USB VER 1.1 and the access speed is slow, the recording may not work well or noise can be recorded.

Note

- It can't play DIVX/XVID and WMV file when playing USB .
- **The USB function of this product does not support all USB devices. For the information on the supported devices, please see the page 63.**

Selecting a Track from USB Device

You can select a desired directory and an MP3 file during the play or when it stopped.

- Before you begin!**
- Connect the external USB storage device to your player.
 - Select USB function by using the USB button.

1 Press the Cursor ▲, ▼ buttons to move the directory.

- Each time you press the button, it will move to the directory before or after.
- This function works only in the remote control.

2 If you want to move the file, press the ◀◀, ▶▶ button shortly.

- It moves the file within the directory.
- If you press the ◀◀, ▶▶ button more times than the number of the files in the directory, it will move over to the next directory.



USB

To use high speed search

- Before you begin!** ♦ Connect the external USB storage device to your player.
♦ Select USB function by using the USB button.

You can search the part you want quickly during the play

Press the ◀◀, ▶▶ button.

- Whenever you press the button, you can search backward or forward 2X → 4X → 8X → 32X → OFF times quickly.

To repeat

Press the REPEAT button during the play.

- REPEAT RANDOM : Plays tracks in random order. (A track that has already been played may be played again.)
- REPEAT 1 : repeat play one track only.
- REPEAT Dir : repeat play the folder .
- REPEAT ALL : repeat play the entire directories.

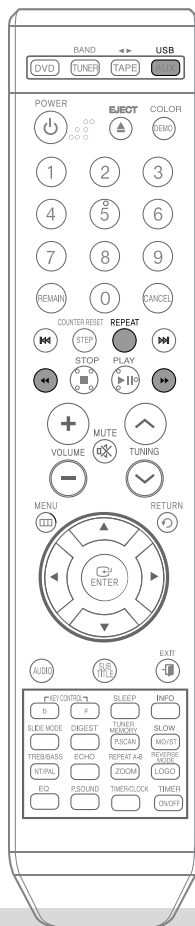

Listening to Radio

You can listen to the chosen band (FM, AM broadcast stations) by using either the automatic or manual tuning operation.

Remote Control Unit

1 Press TUNER/BAND button.

2 Tune in to the desired station.

Automatic Tuning 1 Press the STOP (■) button to select PRESET and then press to select the preset station.

Automatic Tuning 2 Press the STOP (■) button to select "AUTO" and then press button to automatically search the band.

Manual Tuning Press the STOP (■) to select "MANUAL". Briefly press to increase or decrease the frequency incrementally.

Main Unit

1 Press the Function button to select the desired band (FM/AM).

2 Select a broadcast station.

Automatic Tuning 1 Press the STOP (■) button to select PRESET and then press button to select the preset station.

Automatic Tuning 2 Press the STOP (■) button to select "AUTO" and then press button to automatically search the band.

Manual Tuning Press STOP (■) to select MANUAL and then briefly press to tune in to a lower or higher frequency.

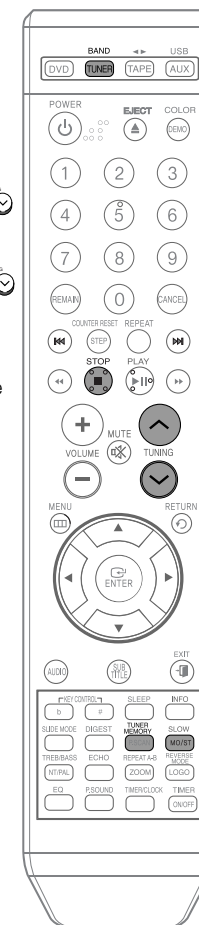

Press MO/ST button to listen in Mono/Stereo. (This applies only when listening to an FM station.)

- Each time the button is pressed, the sound switches between "STEREO" and "MONO".
- In a poor reception area, select MONO for a clear, interference-free broadcast.



Presetting Stations

You can store up to:

- ◆ 15 FM stations
- ◆ 15 AM stations
- FM Frequency Modulation
- AM(MW) Medium Wave

Example: Presetting FM 89.1 in the memory

1 Press the **TUNER(BAND)** button and select the FM band.



2 Press to select "89.10".

- Refer to Step 2 on page 44 to automatically or manually tune in to a station.



3 Press the **TUNER MEMORY** button.

- "PRGM" flashes in the display.



4 Press to select preset number.

- You can select between 1 and 15.



5 Press the **TUNER MEMORY** button.

- Press the **TUNER MEMORY** button before "PRGM" disappears from the display.
- "PRGM" disappears from the display and the station is stored in memory.



6 To preset another station, repeat steps 2 to 5.

To tune in to a preset station, press on the remote control to select a channel.



Listening to a Cassette

Always treat your cassettes with care; refer, if necessary, to the section entitled "Precautions When Using Audio Cassettes" on page 57.

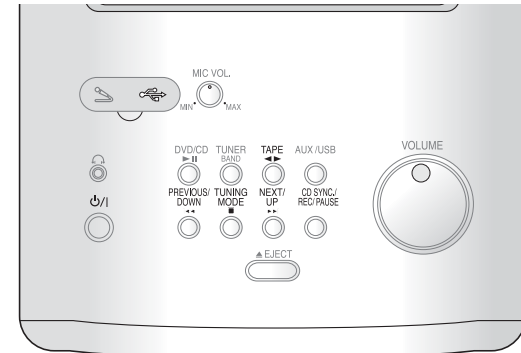

1 Switch the system on by pressing **POWER**.

2 Press **TAPE** on the player to select the Tape function.

3 Press the **PUSH EJECT** () of the cassette deck to open the cassette door and insert a cassette.

- Insert a cassette with the recording/playback side facing the cassette holder, and then push the cassette door shut.

4 Press the button or on the remote control. The cassette starts playing.

- Side A : Tape () button once.
- Side B : Tape () button twice.

5 Press the button or button on the remote control if necessary.

- Rewind the cassette / DOWN button.
- Fast-forward the cassette / button.

6 When you have finished playback, press **STOP** button.

Selecting the cassette Playback Mode/Repeat A↔B /Tape Counter Function

Selecting the Cassette Playback Mode

Your micro component system has three cassette playback modes which enable you to listen to both sides of a cassette automatically.

Press **REVERSE MODE** until the appropriate symbol is displayed.

- : One side of the selected cassette and then stops.
- : One side of the cassette. The other side of the cassette and then stops.
- : Both sides of the cassette indefinitely until you press stop.

REPEAT A↔B Function

Press **REPEAT A↔B** button.

- Use this to listen to a specific section again during playback.
- Set the start and end points of the section you want to repeat 3 times.
- This is a useful when learning a foreign language.
- The TAPE REPEAT function can be used only on sections that are longer than 7 seconds.

- Note**
- You cannot set the end point (B) within 7 seconds after setting the start point (A).
 - Repeat A-B Function is available for TAPE only.

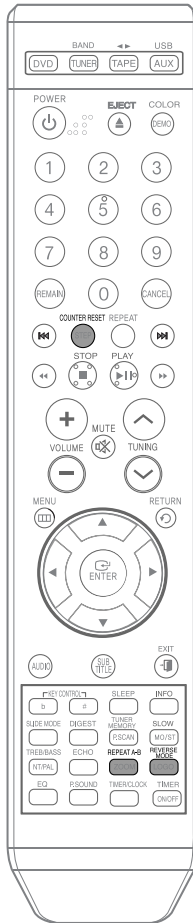

Tape Counter

When playing cassette, a counter is displayed to enable you to take note of the counter value at the start of each track to start playback at the beginning of the track to which you wish to listen.

- Before starting to record a cassette for which you wish to take note of the counter values at the beginning of each track, reset the counter by pressing and hold **COUNTER RESET**.

Timer Function

- The timer enables you to switch the system on or off at specific times.
- If you no longer want the system to be switched on or off automatically, you must cancel the timer.
- Before setting the timer, check that the current time is correct.
- For each step, you have a few seconds to set the required options. If you exceed this time, you must start again.

Example: You wish to wake up to music every morning.

1 Switch the system on by pressing **POWER**.

2 Press **TIMER/CLOCK** until **TIMER** is displayed.

3 Press the **ENTER** button.

- **ON TIME** is displayed (instead of the equalizer symbols) for a few seconds, followed by any switch-on time already set; you can set the timer switch-on time.

4 Set the timer switch-on time.

- Set the hour by pressing or button.
- Press **ENTER**.
 - The minutes flash.
- Set the minutes by pressing or button.
- Press **ENTER**.
 - **OFF TIME** is displayed (instead of the equalizer symbols) for a few seconds, followed by any switch-off time already set; you can now set the timer switch-off time.

5 Set the timer switch-off time.

- Set the hour by pressing or button.
- Press **ENTER**.
 - The minutes flash.
- Set the minutes by pressing or button.
- Press **ENTER**.
 - **VOL 10** is displayed, where 10 corresponds to the volume already set.

6 Press or button to adjust the volume level and press **ENTER**.

- The source to be selected is displayed.

7 Press or button to select the source to be played when the system switches on.

- TAPE (cassette) : Insert a cassette tape.
- TUNER (radio) : a Press **ENTER**. b Select a preset station by pressing Tuning or .
- CD (compact disc) : Load a compact disc.
- USB : Connect the USB.

8 Press **ENTER** to confirm the timer.

9 Press **POWER** to set the system to standby mode.

- is displayed to the top-right of the time, indicating that the timer has been set.
- The system will switch on and off automatically at the required times.

Note

- If the timer switch on and off times are identical, the word **ERROR** is displayed.

MISCELLANEOUS

Canceling the Timer

After having set the timer, it will start automatically as shown by the **TIMER** indication on the display. If you no longer wish to use the timer, you must cancel it.

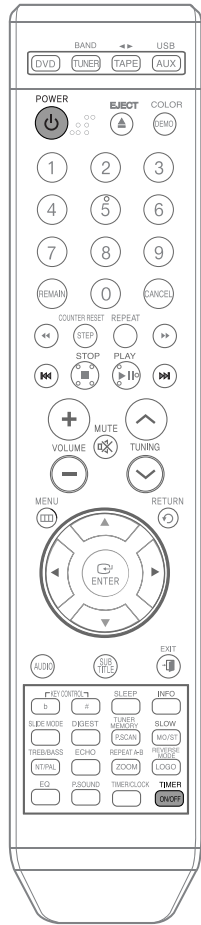

To cancel the timer, press **TIMER ON/OFF** once.

- is no longer displayed.

To resume the timer, press **TIMER ON/OFF** again.

- is displayed again.

Note

- You can cancel the timer while the power is on or while the player is in standby.

Recording a Compact Disc

You can record a compact disc on a cassette in two different ways:

Synchronized recording

This feature enables you to synchronize the start of the recording with the start of the disc or track of your choice.

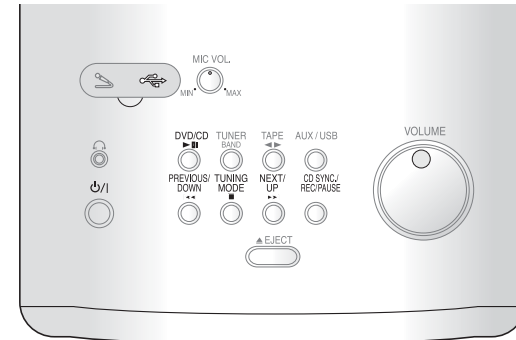

1 Switch the system on by pressing **POWER**.

2 Insert a blank cassette in Deck.

3 Load a compact disc.

- Press the **PUSH/EJECT** button () to open the cassette door, insert a cassette, and then close the cassette door.
- Insert the cassette with the safety tabs.

4 Press the **DVD/CD** () button.

- Use the CD selection (,) buttons to select the desired song.

5 Press and hold **CD SYNC** button.

- When stopped, press the button to start the recording from the first piece of music.
- Press and hold **CD SYNC** button during the playback of CD to start the recording from the first part of the music being played.

6 To stop recording, press button.

Note

- Synchronized recording Function is available for CD only.
- Depending on the Key control Mode, synchronized recording can not work, but then you can press the OPEN button and repeat step 5, 6 return to Synchronized recording.



Recording a Radio Program

You can record a radio program of your choice.
You do not need to adjust the volume, as it has no effect on the recording.

Direct recording

The direct recording mode enables you to start recording with any track on the compact disc.

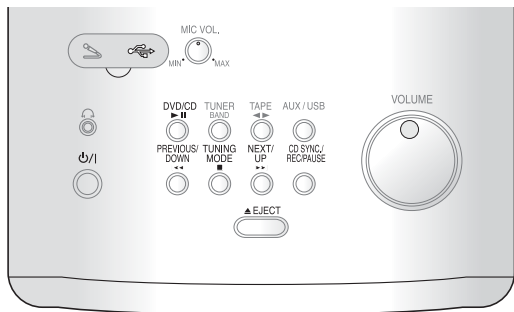

1 Switch the system on by pressing **POWER**.

2 Insert a blank cassette in Deck.

- Press the **PUSH/EJECT** button (▲) to open the cassette door, insert a cassette, and then close the cassette door.
- Insert the cassette with the safety tabs.

3 Load a compact disc.

4 Press the **DVD/CD** (▶/||) button.

- Use the CD selection (◀◀, ▶▶) buttons to select the desired song.

5 Press **REC/ PAUSE** button.

- Recording will begin.
- To stop recording, press ■ button.

Note

- The cassette tape you want to record on must have the safety tabs intact.

1 Switch the system on by pressing **POWER**.

2 Insert a blank cassette in Deck.

3 Select the **TUNER** function by pressing **TUNER/BAND**.

4 Select the radio station that you wish to record by pressing **◀◀/DOWN** or **UP/▶▶** button .

5 Press **REC/PAUSE** button.

- REC is displayed and recording starts.

6 To stop recording, press ■ button.

EQ/Sound Mode/Treble/Bass Function

Your micro component system is equipped with a preset equalizer that allows you to choose the most appropriate balance between treble and bass frequencies, according to the type of music you are listening to.

The function of Power Sound amplifies bass and improves high key or bass twice as much for you to appreciate powerful real sound.

EQ Function

Press **EQ** control until the required option is selected.

- Press the button repeatedly to select "PASS→POP→ROCK→CLASS→JAZZ→S.BASS".
- **S.BASS Function** : S.Bass function emphasizes the bass sound to produce the effect of explosion or booms.

Selecting SOUND MODE

Press **P.SOUND** button until the required option is selected.

- Press the button repeatedly to select "P.SOUND→OFF".
- **P.SOUND Function** : You can experience the powerful and realistic sound by amplifying bass and improving the sound quality of high- and low-pitched sounds by two-fold.

Sleep Timer Function / Mute Function

Sleep Timer Function

You can set the time that the DVD player will shut itself off.

Press **SLEEP** button.

- Each time the button is pressed, the selection changes as follows: 90 MIN → 60 MIN → 45 MIN → 30 MIN → 15 MIN → OFF.

90 MIN

To confirm the sleep timer setting, press **SLEEP** button.

- The remaining time before the DVD player will shut itself off is displayed.
- Pressing the button again changes the sleep time from what you have set earlier.

To cancel the sleep timer, press **SLEEP** button until OFF appears on the display.

Mute Function

This is useful when answering a doorbell or telephone call.

Press **MUTE** button.

- 'MUTE' appears in the display.
- To turn off mute, press the button again.

MUTE

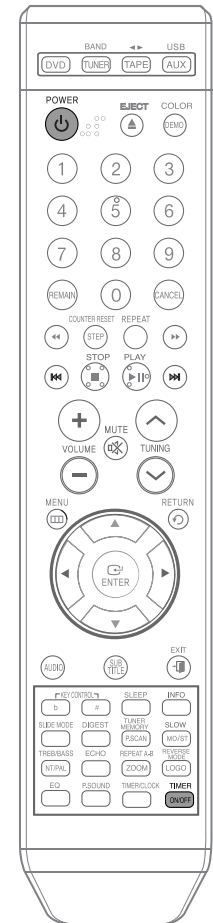
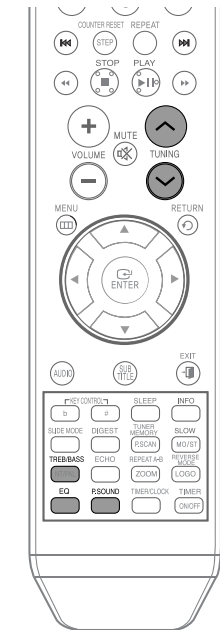

Treble Level Function Bass Level Function

Treble Control function stresses high tones providing thudding sound effects.

BASS function stresses low tones providing thudding sound effects.

Press button until **TREB 0** is displayed.

- Please press **TREB/BASS** button and then press to select from **TREB -4** to **TREB 4**.
- You can select the level of high tones you desire.

Press button until **BASS 0** is displayed.

- Please press **TREB/BASS** button and then press to select from **BASS -4** to **BASS 4**.
- You can select the level of low tones you desire.



DEMO / COLOR Function

DEMO Function

You can view the various functions available on your system.

Press and hold **DEMO/COLOR** button.

- The various functions available are listed in turn on the display.
- All these functions are described in detail in this booklet. For instructions on how to use them, refer to the appropriate sections.

COLOR Function

You can adjust the color of the display on the main unit so it won't interfere with your movie viewing.

Press **DEMO/COLOR** button.

- Each time the button is press, the colors changes as follows: **AUTO**→**CYAN** → **GREEN**→ **RED**→ **BLUE**→ **VIOLET**→**Y.GREEN**→**WHITE** → **OFF**.

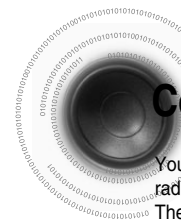
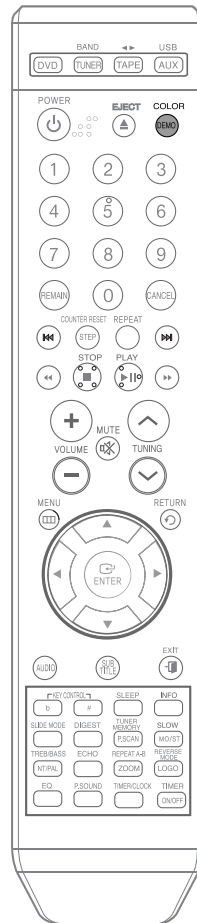

Connecting Headphones/Microphone(option)

You can connect a set of headphones to your micro component system so that you can listen to music or radio programmers without disturbing other people in the room. The earphones must have a 3.5ø jack or an appropriate adapter.

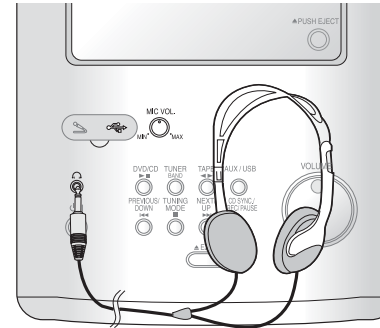

Connect the headphones to the **PHONES** jack on the top panel.

- The loudspeakers are no longer used to output the sound.

Note

- Prolonged use of headphones at a high volume may damage your hearing.

Plug the microphone with a 3.5ø MIC jack into microphone terminal.

- Connect the Microphone.
- Push the **MIC LEVEL** knob first and then Turn it to adjust the **MIC** level.
- Press the **ECHO** button to select **ECHO1**,**ECHO2**,and **ECHO OFF**.
- During using the microphone ,you can press the **REC/PAUSE** button to record your favorite.



Key Control

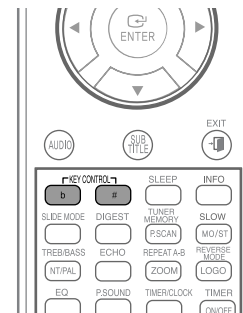

Press the **KEY CONTROL** button to adjust the key to your voice. The (-3~+3)7 steps key control you can select .

Result: Each time the **KEY CONTROL** #, **b** button is pressed, the following appears on the TV screen:

b : Low-Pitched
: High-Pitched

- Each time # button is pressed, the key is increased, and each time **b** button is pressed, the key is decreased .
- The function only can available for CD/VCD in stop mode when microphone is connect,it can not available for DVD and MP3 .
- The function for "key control" can not disappear immediately if you unplugged MIC.

Cautions on Handling and Storing Discs

Small scratches on the disc may reduce sound and picture quality or cause breaks in playback. Be especially careful not to scratch discs when handling them.

● Handling discs



Do not touch the playback side of the disc. Hold the disc by the edges so that fingerprints will not get on the surface.
Do not stick paper or tape on the disc.

● Handling and Storing Discs



When you get fingerprints or dirt on the disc, clean it with a mild detergent diluted in water and wipe with a soft cloth.

- When cleaning, wipe gently from the inside to the outside of the disc.

Note

- Condensation may form if warm air comes into contact with cold parts inside the player. When condensation forms inside the player, the player may not operate correctly. If this occurs, remove the disc and let the player stand for 1 or 2 hours with the power on.

● Precautions When Using Audio Cassettes

- Check that the tape in the cassette is sufficiently taut.
- To prevent erasing a cassette that you wish to keep, remove the safety tab on the upper edge of the cassette. To record a cassette, where the tab has been broken, simply cover the opening with adhesive tape.
- When you have finished playing a cassette, always put it back in its case.
- Store your cassettes in a clean place, out of direct sunlight, where they will not be exposed to high temperatures.
- Avoid using 120-minute cassettes as they place unnecessary strain on the tape mechanism.

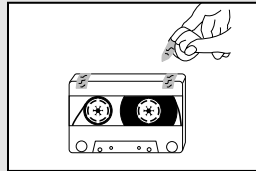
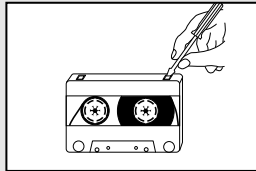
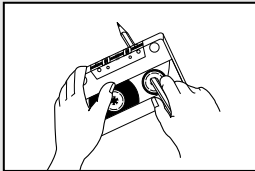

Before Calling for Service

Refer to the chart below when this unit does not function properly. If the problem you are experiencing is not listed below or if the instruction below does not help, turn off the unit, disconnect the power cord, and contact the nearest authorized dealer or Samsung Electronics Service Center.

Symptom	Check/Remedy
I can not eject the disc	<ul style="list-style-type: none"> • Is the power cord plugged securely into the outlet? • Turn off the power and then turn it back on.
Playback does not start.	<ul style="list-style-type: none"> • Check the region number of the DVD. DVD discs purchased from abroad may not be playable. • CD-ROMs and DVD-ROMs cannot be played on this DVD player. • Make sure that the rating level is correct.
The remote control does not work.	<ul style="list-style-type: none"> • Is the remote control being operated within its operation range of angle and distance? • Are the batteries exhausted?
Playback does not start immediately when the Play/Pause button is pressed.	<ul style="list-style-type: none"> • Are you using a deformed disc or a disc with scratches on the surface? • Wipe the disc clean.
Sound is not produced.	<ul style="list-style-type: none"> • No sound is heard during fast playback, slow playback, and step motion playback. • Are the speakers connected properly? Is the speaker setup correctly customized? • Is the disc severely damaged?
Picture does not appear, sound is not produced, or the disc tray opens 2 to 5 seconds later.	<ul style="list-style-type: none"> • Was the DVD player suddenly moved from a cold place to a warm one? When condensation forms inside the player, remove the disc and let the player stand for 1 or 2 hours with the power on. (You can use the player again after condensation disappears.)
<ul style="list-style-type: none"> • Disc is rotating but no picture is produced. • Picture quality is poor and picture is shaking. 	<ul style="list-style-type: none"> • Is the TV power on? • Are the video cables connected properly? • Is the disc dirty or damaged? • A poorly manufactured disc may not be playable.



Notes on Discs

Disc Recording Format

CD-R Discs

- Depending on the disc recording device (CD-Recorder or PC) and the condition of the disc, some CD-R discs may not be playable.
- Use a 650MB/74 minute CD-R. Avoid CD-R media, as they may not be playable.
- If possible, do not use CD-RW (Rewritable) media, as they may not be playable.
- Only the CD-Rs that are properly "closed" can be fully played. If the session is closed but the disc is left open, you may not be able to fully play the disc.

CD-R MP3 Discs

- Only CD-R discs with MP3 files in ISO 9660 or Joliet format can be played.
- MP3 file names should be 8 characters or less in length and contain no blank spaces or special characters (. / = +).
- If the name of a file is in Korean, the name will be displayed on the TV screen in Korean and * will be shown in the display of the main unit.
- Use discs recorded with a compression/decompression data rate greater than 128Kbps.
- Only files with the ".mp3" and ".MP3" extensions can be played.
- Only a consecutively written Multisession disc can be played. If there is a blank segment in the Multisession disc, the disc can be played only up to the blank segment.
- If the disc is not closed, it will take longer to begin playback and not all of the recorded files may be played.
- For files encoded in Variable Bit Rate (VBR) format, i.e. files encoded in both low bit rate and high bit rate (e.g., 32Kbps - 320Kbps), the sound may skip during playback.
- If more than 500 tracks are recorded on a single CD, a maximum of 500 tracks can be played.
- If more than 300 folders are recorded on a single CD, a maximum of 300 folders can be played.

What is MP3?

MP3 is short for MPEG-1 Audio Layer 3 and MPEG is an acronym for Moving Pictures Experts Group. MP3 is a file format with compression ratio of 1:12 (128 Kbps*) That is, you can use MP3 format to record about 12 times the usual amount of data on a regular CD.

CD-R JPEG Discs

- Only files with the ".jpeg" and ".JPEG" extensions can be played.
- If the disc is not closed, it will take longer to start playing and not all of the recorded files may be played.
- Only CD-R discs with JPEG files in ISO 9660 or Joliet format can be played.
- JPEG file names should be 8 characters or less in length and contain no blank spaces or special characters (. / = +).
- Only a consecutively written multisession disc can be played. If there is a blank segment in the multisession disc, the disc can be played only up to the blank segment.
- A maximum of 9,999 images can be stored on a single CD.
- When playing a Kodak/Fuji Picture CD, only the JPEG files in the picture folder can be played.
- Picture discs other than Kodak/Fuji Picture CDs may take longer to start playing or may not play at all.



Symptom	Check/Remedy
Audio language and subtitles do not work.	<ul style="list-style-type: none"> • Audio language and subtitles will not work for DVDs not containing them. And depending on the disc, they may work differently.
Menu screen does not appear even when the menu function is selected.	<ul style="list-style-type: none"> • Are you using a disc that does not contain menus?
Aspect ratio cannot be changed.	<ul style="list-style-type: none"> • You can play 16:9 DVDs in 16:9 WIDE mode, 4:3 LETTER BOX mode, or 4:3 PAN SCAN mode, but 4:3 DVDs can be seen in 4:3 ratio only. Refer to the DVD disc jacket and then select the appropriate function.
The tape does not start playing	<ul style="list-style-type: none"> • The TAPE function has not been selected. • The cassette has not been inserted correctly. • The cassette player has not been closed. • The tape is either slack or broken.
The volume falls off The cassette is not erased correctly There is excessive wow and flutter	<ul style="list-style-type: none"> • The audio heads are dirty. • The rollers or drive capstans are dirty. • The tape is worn.
Can't receive radio broadcast.	<ul style="list-style-type: none"> • Is the antenna connected properly? • If the antenna's input signal is weak, install an external FM antenna in an area with good reception.
<ul style="list-style-type: none"> • The main unit is not working. (Example: The power goes out or strange noise is heard.) • The DVD player is not working normally. 	<ul style="list-style-type: none"> • Turn off the power and hold the STOP button on the main unit for longer than 5 seconds. <p>Using the RESET function will erase all stored settings. Do not use this unless necessary.</p>
The password for rating level has been forgotten.	<ul style="list-style-type: none"> • While the player is in the No Disc mode, hold the main unit's TUNING MODE/■ button for longer than 5 seconds. "INITIAL" appears on the display and all settings will return to the default values. • Press the POWER button. <p>Using the RESET function will erase all stored settings. Do not use this unless necessary.</p>



Notes on Terminology



Specifications

ANGLE	Recorded onto some DVD discs are scenes which have been simultaneously shot from a number of different angles (the same scene is shot from the front, from the left, from the right, etc.). With such discs, the Angle button can be used to change the angle of view for specific scenes.
CHAPTER NUMBER	These numbers are recorded on DVD discs. A Title is subdivided into many sections, each of which is numbered, and specific parts of the video can be searched quickly using these numbers.
DVD	A high-density optical disc on which high-quality pictures and sound have been recorded by means of digital signals. Incorporating a new video compression technology (MPEG-2) and high-density recording technology, a DVD disc comprises two 0.6 mm thick discs bonded together.
PCM	An acronym for Pulse Code Modulation - another name for digital audio.
PBC (PLAYBACK CONTROL)	This is recorded on a video CD (version 2.0). Selected scenes or information can be chosen from the menu displayed on the TV monitor.
REGION NUMBER	Both the DVD player and DVD discs are encoded with a region number. If the region number on the DVD disc does not correspond to the region number of the DVD player, the player cannot play the disc.
SUBTITLES	Translated appearing at the bottom of the screen. A DVD disc can contain up to 32 subtitle languages.
TITLE NUMBER	These numbers are recorded on DVD discs. When a disc contains two or more movies, these movies are numbered as Title 1, Title 2, etc.
TRACK NUMBER	These numbers are assigned to the tracks which are recorded on video and audio CDs. They enable specific tracks to be located quickly.
VIDEO CD	Contains recordings of pictures and sound whose quality is roughly comparable to that of video tape. This player also supports video CDs with playback control (version 2.0).
	5.1 (or 6) Channel Digital Surround sound reproduced from DVDs and LDs recorded as a digital signals (with  disc marking). With better sound quality, dynamic range, and directionality than traditional Dolby surround technology, you can enjoy dynamic, realistic sound.

GENERAL	Power consumption	60W
	Weight	4.3Kg
	Dimensions (W x H x D)	170 x 175 x 292 mm
	Operating Temperature Range	+5°C~+35°C
F TUNER	Usable Sensitivity	10dB
	S/N Ratio	55dB
	Distortion	0.8%
MW TUNER	Usable Sensitivity	56dB
	S/N Ratio	40dB
	Distortion	2%
VIDEO OUTPUT	Composite Video	1.0Vp-p(75Ω load)
	Component Video	Y : 1.0Vp-p(75Ω load)
		Pr : 0.7Vp-p(75Ω load)
		Pb:0.7Vp-p(75Ω load)
A M P L I F I E R	Speaker output	20W/CH
	Frequency range	20Hz~20kHz
	S/N Ratio	75dB
	Channel separation	50dB
	Input sensitivity	(AUX)500mV
S P E A K E R	Impedance	6Ω x 2
	Frequency range	20 Hz - 20 KHz (± 1 dB)
	Output sound pressure level	84dB/W/M
	Rated input	20W
	Maximum input	40W
	Dimensions (W x H x D)	170(W) x 160(H) x 175(D) mm
	Weights	1.4 Kg

USB Feature Supported Player

Digital Camera

Product	Company	Type
Finepix-A340	Fuji	Digital Camera
Finepix-F810	Fuji	Digital Camera
Finepix-F610	Fuji	Digital Camera
Finepix-450	Fuji	Digital Camera
Finepix S7000	Fuji	Digital Camera
Finepix A310	Fuji	Digital Camera
KD-310Z	Konica	Digital Camera
Finecam SL300R	Kyocera	Digital Camera
Finecam SL400R	Kyocera	Digital Camera
Finecam SSR	Kyocera	Digital Camera
Finecam Xt	Kyocera	Digital Camera
Dimage-Z1	Minolta	Digital Camera
Dimage Z1	Minolta	Digital Camera
Dimage X21	Minolta	Digital Camera
Coolpix4200	Nikon	Digital Camera
Coolpix4300	Nikon	Digital Camera
Coolpix 2200	Nikon	Digital Camera
Coolpix 3500	Nikon	Digital Camera
Coolpix 3700	Nikon	Digital Camera
Coolpix 4100	Nikon	Digital Camera
Coolpix 5200	Nikon	Digital Camera
Stylus 410 digital	Olympus	Digital Camera
300-digital	Olympus	Digital Camera
U300	Olympus	Digital Camera
X-350	Olympus	Digital Camera
C-760	Olympus	Digital Camera
C-5060	Olympus	Digital Camera
X1	Olympus	Digital Camera
U-mini	Olympus	Digital Camera
Lumix-FZ20	Panasonic	Digital Camera
DMC-FX7GD	Panasonic	Digital Camera
Lumix LC33	Panasonic	Digital Camera
LUMIX DMC-F1	Panasonic	Digital Camera
Optio-S40	Pentax	Digital Camera
Optio-S50	Pentax	Digital Camera
Optio 33LF	Pentax	Digital Camera
Optio MX	Pentax	Digital Camera
Digimax-420	Samsung	Digital Camera
Digimax-400	Samsung	Digital Camera
Sora PDR-T30	Toshiba	Digital Camera
Coolpix 5900	Nikon	Digital Camera
Coolpix S1	Nikon	Digital Camera
Coolpix 7600	Nikon	Digital Camera
DMC-FX7	Panasonic	Digital Camera
Dimage Xt	Minolta	Digital Camera
AZ-1	Olympus	Digital Camera

USB Flash Disk

Product	Company	Type
Cruzer Micro	Sandisk	USB 2.0 USB Flash Drive 128M
Cruzer Mini	Sandisk	USB 2.0 128M
Cruzer Mini	Sandisk	USB 2.0 256M
SONY Micro Vault	Sony	USB 2.0 64MB
FLEX DRIVE	Serotech	USB 2.0 32MB
AnyDrive	A.L.tech	USB 2.0 128MB
XTICK	LG	USB 2.0 128M
Micro Mini	lomega	USB 2.0 128M
iFlash	Imation	USB 2.0 64M
LG	XTICK(M)	USB 2.0 64M
RiDATA	EZdrive	USB 2.0 64M

MP3 Player

Product	Company	Type
Creative MuVo NX128M	Creative	128 MB MP3 Player
Iriver H320	Iriver	20G HDD MP3 Player
YH-920	Samsung	20G HDD MP3 Player
YP-T7	Samsung	MP3 Player
YP-MT6	Samsung	MP3 Player
YP-T6	Samsung	MP3 Player
YP-53	Samsung	MP3 Player
YP-ST5	Samsung	MP3 Player
YP-T5	Samsung	MP3 Player
YP-60	Samsung	MP3 Player
YP-780	Samsung	MP3 Player
YP-35	Samsung	MP3 Player
YP-55	Samsung	MP3 Player
iAUDIO U2	Cowon	MP3 Player
iAUDIO G3	Cowon	MP3 Player
iAudio M3	Cowon	HDD MP3 Player
SH-M500L	Sharp	256MB MP3 Player
H10	Iriver	MP3 Player
YP-T5 VB	Samsung	MP3 Player
YP-53	Samsung	256MB MP3 Player

USB External HDD

Product	Company	Type
MOMOBAY UX-2	Dvico	USB 2.0

Contact SAMSUNG WORLD WIDE

If you have any questions or comments relating to Samsung products, please contact the SAMSUNG customer care center.

Region	Country	Customer Care Center	Web Site
North America	CANADA	1-800-SAMSUNG (7267864)	www.samsung.com/ca
	MEXICO	01-800-SAMSUNG (7267864)	www.samsung.com/mx
	U.S.A	1-800-SAMSUNG (7267864)	www.samsung.com
Latin America	ARGENTINE	0800-333-3733	www.samsung.com/ar
	BRAZIL	0800-124-421 4004-0000	www.samsung.com/br
	CHILE	800-726-7864 (SAMSUNG)	www.samsung.com/cl
	COSTA RICA	0-800-507-7267	www.samsung.com/latin
	ECUADOR	1-800-10-7267	www.samsung.com/latin
	EL SALVADOR	800-6225	www.samsung.com/latin
	GUATEMALA	1-800-299-0013	www.samsung.com/latin
	JAMAICA	1-800-234-7267	www.samsung.com/latin
	PANAMA	800-7267	www.samsung.com/latin
	PUERTO RICO	1-800-682-3180	www.samsung.com/latin
	REP. DOMINICA	1-800-751-2676	www.samsung.com/latin
	TRINIDAD & TOBAGO	1-800-7267-864	www.samsung.com/latin
	VENEZUELA	0-800-100-5303	www.samsung.com/latin
COLOMBIA	01-8000112112	www.samsung.com.co	
Europe	BELGIUM	02 201 2418 844 000 844	www.samsung.com/be
	CZECH REPUBLIC	Distributor pro Českou republiku : Samsung Zrt., česká organizační složka Vyskočilova 4, 14000 Praha 4	www.samsung.com/cz
	DENMARK	38 322 887	www.samsung.com/dk
	FINLAND	09 693 79 554	www.samsung.com/fi
	FRANCE	3260 SAMSUNG or 08 25 08 65 65 (€ 0,15/Min)	www.samsung.com/fr
	GERMANY	01805 - 121213 (€ 0,14/Min)	www.samsung.de
	HUNGARY	06-80-SAMSUNG (7267864)	www.samsung.com/hu
	ITALIA	800-SAMSUNG (7267864)	www.samsung.com/it
	LUXEMBURG	0032 (0)2 201 24 18	www.samsung.lu
	NETHERLANDS	0900 20 200 88 (€ 0,10/Min)	www.samsung.com/nl
	NORWAY	231 627 22	www.samsung.com/no
	POLAND	0 801 801 881	www.samsung.com/pl
	PORTUGAL	80 8 200 128	www.samsung.com/pt
	SLOVAKIA	0800-SAMSUNG (726786)	www.samsung.com/sk
	SPAIN	902 10 11 30	www.samsung.com/es
	SWEDEN	08 585 367 87	www.samsung.com/se
	U.K	0870 SAMSUNG (7267864)	www.samsung.com/uk
Republic of Ireland	0818 717 100	www.samsung.com/uk	
Switzerland	800-7267864	www.samsung.com/ch	
CIS	RUSSIA	8-800-200-0400	www.samsung.ru
	KAZAHSTAN	8-800-080-1188	www.samsung.kz
	UZBEKISTAN	8-800-120-0400	www.samsung.uz
	UKRAINE	8-800-502-0000	www.samsung.com/ur
	LITHUANIA	8-800-77777	www.samsung.lt
	LATVIA	800-7267	www.samsung.com/lv/index.htm
	ESTONIA	800-7267	www.samsung.ee
Asia Pacific	AUSTRALIA	1300 362 603	www.samsung.com/au
	CHINA	800-810-5858, 010-6475 1880	www.samsung.com.cn
	HONG KONG	3698 - 4698	www.samsung.com/hk
	INDIA	3030 8282 1800 110011	www.samsung.com/in
	INDONESIA	0800-112-8888	www.samsung.com/id
	JAPAN	0120-327-527	www.samsung.com/jp
	MALAYSIA	1800-88-9999	www.samsung.com/my
	PHILIPPINES	1800-10-SAMSUNG (7267864)	www.samsung.com/ph
	SINGAPORE	1800-SAMSUNG (7267864)	www.samsung.com/sg
	THAILAND	1800-29-3232 02-689-3232	www.samsung.com/th
	TAIWAN	0800-329-999	www.samsung.com/tw
VIETNAM	1 800 588 889	www.samsung.com/vn	
Middle East & Africa	SOUTH AFRICA	0860 7267864 (SAMSUNG)	www.samsung.com/za
	U.A.E	800SAMSUNG (7267864) 8000-4726	www.samsung.com/mea